



THE CORPORATION OF THE CITY OF BRAMPTON

BY-LAW

Number 75 - 2023

To amend the Official Plan of the City of Brampton Planning Area



The Council of the Corporation of the City of Brampton, in accordance with the provisions of the Planning Act, RS.O. 1990, c.P.13, hereby ENACTS as follows:

1. Amendment Number OP 2006- 242 to the Official Plan of the City of Brampton Planning Area is hereby adopted and made part of this By-law.

ENACTED and PASSED this 3rd day of May, 2023.

Approved as to
form.
2023/04/25
SDSR

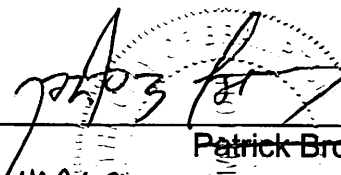
Approved as to
content.
2023/04/25
AAP

Patrick Brower, Mayor
HAREKAT SINGH, DEPUTY MAYOR

Peter Fay, City Clerk

(OZS-2022-0043)

AMENDMENT NUMBER OP 2006- 242

To the Official Plan of the
City of Brampton Planning Area

1.0 Purpose:

The purpose of this amendment is to amend Schedule 5 of the Highway 410 and Steeles Secondary Plan (SPA 5) to revise the land use designation from "General Employment 2" to "Prestige Employment".

2.0 Location:

The lands subject to this amendment are located at the intersection of Biscayne Crescent and First Gulf Boulevard, and are municipally known as 150 First Gulf Boulevard. The lands comprise of 1 parcel totaling 0.03 hectares in area, and have a frontage of approximately 41 metres on Biscayne Crescent and are legally described as Part of Lot 15, Concession 2, E.H.S.

3.0 Amendments and Polices Relative Thereto:

3.1 The document known as the Official Plan of the City of Brampton Planning Area is hereby amended:

1. By adding to the list of amendments pertaining to Secondary Plan Area 5: Highway 410 and Steeles Secondary Plan as set out in Part II: Secondary Plans thereof, Amendment Number OP 2006- 242.

3.2 The document known as Secondary Plan Area 5 - Highway 410 and Steeles Secondary Plan, as amended, is hereby further amended as follows

1. Amending on Schedule 5 of Brampton Highway 410 and Steeles Secondary Plan Area 5, the land use designation of the lands outlined on Schedule A to this Amendment from "General Employment 2" to "Prestige Employment".

LANDS TO BE REDESIGNATED FROM "GENERAL EMPLOYMENT 2" TO "PRESTIGE EMPLOYMENT"

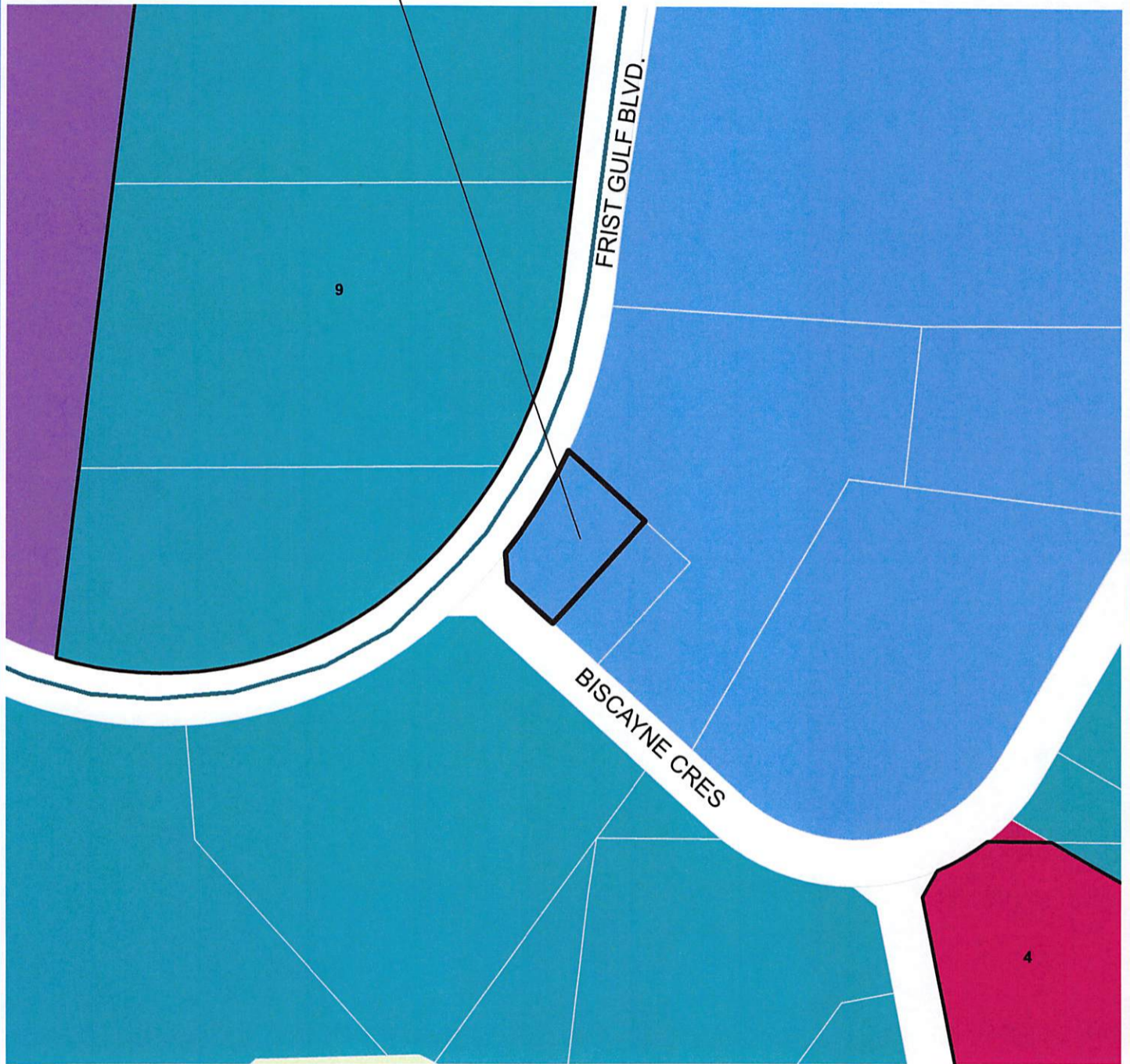

EXTRACT FROM SCHEDULE SP5(A) OF THE DOCUMENT KNOWN AS THE HIGHWAY 410 AND STEELES SECONDARY PLAN

HIGHWAY 410 AND STEELES SECONDARY PLAN AREA 5 - SCHEDULE 5

EMPLOYMENT	INSTITUTIONAL	OPEN SPACE	COMMERCIAL	ROADS	SPECIAL SITE AREA
GENERAL EMPLOYMENT 1	SECONDARY SCHOOL	RECREATIONAL OPEN SPACE	HIGHWAY AND SERVICE COMMERCIAL	COLLECTOR ROAD	SPECIAL SITE AREA
GENERAL EMPLOYMENT 2		NATURAL HERITAGE SYSTEM	HIGHWAY COMMERCIAL	MINOR ARTERIAL ROAD	SPECIAL POLICY AREA
PRESTIGE EMPLOYMENT			SERVICE COMMERCIAL	MAJOR ARTERIAL ROAD	
MIXED EMPLOYMENT COMMERCIAL				PROVINCIAL HIGHWAY	

