



THE CORPORATION OF THE CITY OF BRAMPTON

BY-LAW

Number 430-2006

To authorize the acquisition of certain lands from
Ranburne Holdings Limited for road realignment
purposes

Section 6 of the *Municipal Act 2001* authorizes the Council of every corporation to pass a by-law for acquiring or expropriating any land required for the purposes of the corporation. The Council of The Corporation of the City of Brampton has determined that it is necessary and in the interest of The Corporation of the City of Brampton to acquire the lands herein described for road widening purposes.

NOW THEREFORE The Council of The Corporation of the City of Brampton **ENACTS AS FOLLOWS:**

1. The Mayor and City Clerk are hereby authorized to execute on behalf of The Corporation of the City of Brampton an agreement of purchase and sale for the City's purchase of approximately 3.14 acres of Part of Block 124, Plan 43M-1488 shown as "Area 1" on Schedule "A" attached hereto for road widening purposes, from Ranburne Holdings Limited, on terms acceptable to the Commissioner of Works and Transportation and in a form of agreement approved by the City Solicitor, together with all other documents that in the opinion of the City Solicitor are necessary to effect the purchase of the said land.

READ a FIRST, SECOND and THIRD TIME and PASSED in Open Council this 13th day of December, 2006.

Approved as to form Law Dept. <u>MK</u> 11 29 06
--

Approved as to content MAS Dept. <u>[Signature]</u> Nov 29/06

[Signature]
SUSAN FENNELL MAYOR

[Signature]
K. ZAMMIT CLERK

Schedule "A"



NOTE: Measurements are approximate

LEGEND:

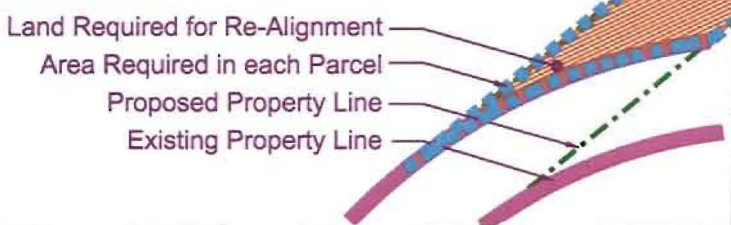

Legal Description
Part of Lots 11 and 12
Concession 2
East of Hurontarion Steet



CITY OF BRAMPTON
WORKS & TRANSPORTATION
T.W. MULLIGAN, P. Eng., COMMISSIONER OF WORKS and TRANSPORTATION

REGISTERED OWNER	PROPERTY REQ'D		
10-07-0-014-98500-0000	Area 1	Area 2	Area 3
RANBURNE HOLDINGS LIMITED	12707 sq m	9383 sq m	3332 sq m
3-26 LESMILL RD	3.14 ac	2.23 ac	0.82 ac
TORONTO ON M3B 2T5	136777 sq ft	100997 sq ft	35872 sq ft

BOVAIRD DRIVE

PROPERTY PLAN
Bovaird Drive

Signature of acknowledgement

Drawn By: RS Scale: N.T.S. Feb 20 2006