

The Century Gardens Youth Hub is an essential piece of social infrastructure meant to address youth mental health, violence, and food insecurity. It offers a 'one-stop-shop' for at-risk youth to access recreational, health, and social programming in a safe setting.

CENTURY GARDENS YOUTH HUB **CITY OF BRAMPTON**





CANADA’S FASTEST GROWING CITY

Since 2016, Brampton has been the fastest growing municipality in Canada. With a strong history of immigration, it is one of the country’s most diverse communities with 81% of the population in the global majority and 51% South Asian. With an average age of 36.5 years, Brampton has one of the youngest populations in the country compared to the national average of 41.0 years. Located in Brampton’s Madoc neighbourhood, the site is home to a growing youth population with many living in intergenerational households, offers easy access to Brampton’s well-used transit system, and has been identified as having inadequate access to social infrastructure. Located on a lot formerly occupied by a lawn bowling club, and directly adjacent to the Century Gardens Recreation Centre and Park and the Gordon Graydon Public School, the Youth Hub is an essential component of a burgeoning civic centre.



DEDICATED PUBLIC SPACE FOR YOUTH

The project’s vision is centred on themes emerging from extensive City-led public consultation with the community, youth-serving organizations, and stakeholders. Themes underpinning this vision emphasize the need to create a safe, accessible facility where flexible, youth-focused spaces and programming are prioritized through design. The 1,100 m2 building includes a range of spaces, from a dedicated e-sports area, communal kitchen, and flexible multi-purpose rooms, to more private study and counseling spaces to access critical employment and public health services. Complementing this is an extensive outdoor program, including an amphitheatre, half-court, community garden, and various seating areas. This innovative approach, uniting traditionally separate programs, targets pressing issues in Brampton’s youth community. It addresses concerns such as limited economic prospects, youth isolation, low community involvement, and safety. The aim is to create high-quality indoor and outdoor spaces for young people aged 14–29, ensuring year-round accessibility.



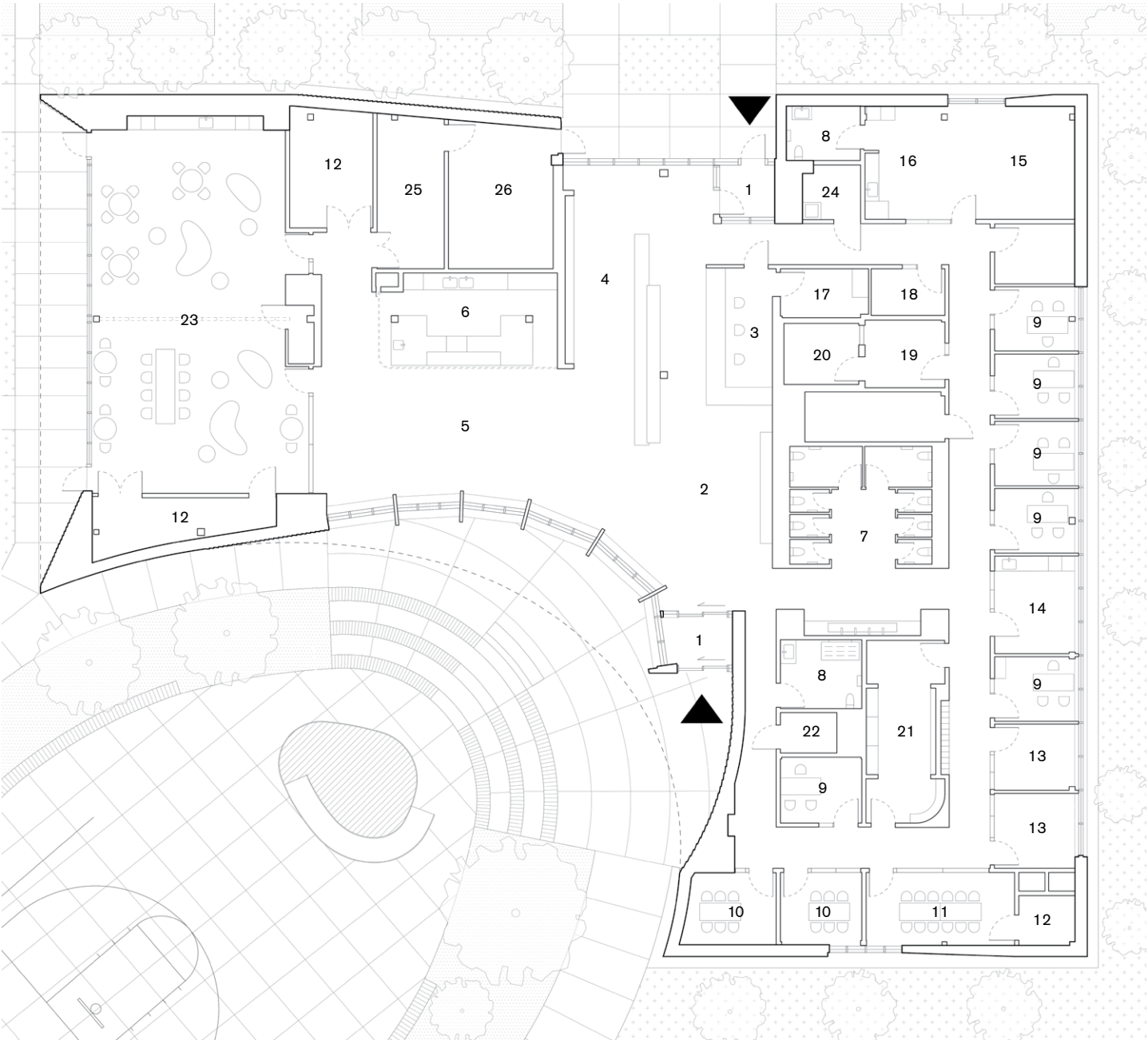

Ground Floor Plan 1:100

- 1. VESTIBULE
- 2. SEATING AREA
- 3. RECEPTION
- 4. E-SPORTS
- 5. GAMES
- 6. TEACHING KITCHEN
- 7. WASHROOM
- 8. UNIVERSAL WASHROOM
- 9. OFFICE
- 10. MEETING ROOM
- 11. CONFERENCE
- 12. STORAGE
- 13. IDEATION
- 14. ARTIST
- 15. ADMIN OFFICE
- 16. KITCHENETTE
- 17. SECURE
- 18. CONSULT
- 19. CONTROL ROOM
- 20. RECORDING STUDIO
- 21. SENSORY ROOM
- 22. ELEC.CLOSET
- 23. MULTI-PURPOSE ROOM
- 24. CENTRAL CARETAKING
- 25. ELECTRICAL
- 26. MECHANICAL

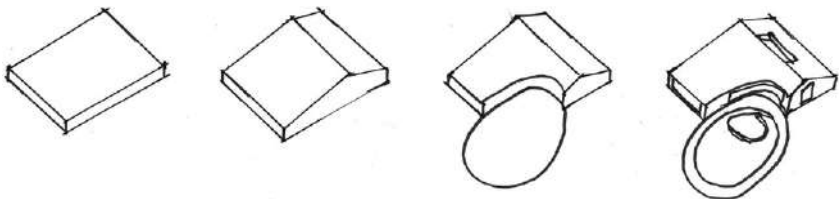

SOCIAL HEART

The amphitheatre serves as the focal point for the project; forming the nucleus of activity, surrounding programed spaces orbit around it. When moving further from this social core, spaces become more private and intimate. Contrary to most architectural approaches, this project let's landscape lead where desired space of the exterior defines the site and delineates a singular symbiotic expression as a salient boolean extrusion.

CONNECTIVITY

Starting with a simple rectangular form, the building's shape responds to the strong north-south axis on the site. This axis is characterized by a slight elevation in the roof plane and strengthened through the alignment of entryways. These entrances are served by generous, sloped walkways, notably the path that lines the southern edge of the amphitheatre, guiding people from the drop off area to the main entrance of the building.

SENSE OF CHOICE

The design offers diverse spatial experiences within a compact footprint. Active public spaces dominate the south side, while tranquil intimate areas cluster to the north. This arrangement empowers youth to choose spaces that suit their evolving preferences. Versatile furniture, adaptable AV, and flexible materials further enhance sense of choice and adaptability.

INCLUSIVITY

Glazing strategically punctuates the brick façade; carefully situated and framed to maximize visual connections between indoor and outdoor programs, these openings foster an inclusive and connected experience that showcases the facility's flexible nature. South and west floor-plates extend outward from the building into the landscape, forming a raised porch around its public face. On the west side, it steps down to create a viewing platform overlooking the amphitheatre and a future soccer pitch.

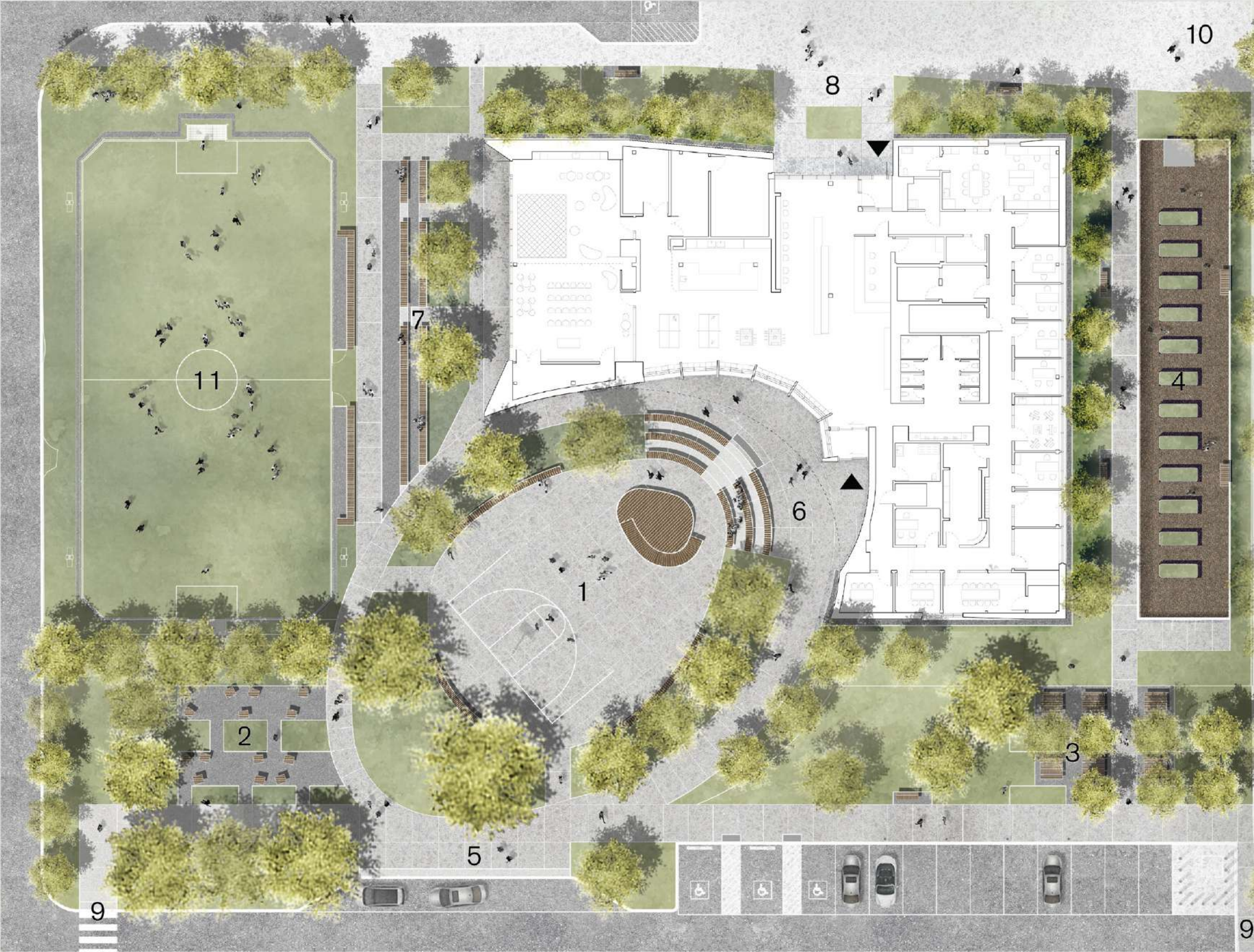

Site Plan

- 1. PLAZA & AMPHITHEATRE
- 2. SEATING GARDEN
- 3. PICNIC GROUND
- 4. COMMUNITY GARDEN
- 5. WELCOME PLAZA
- 6. PLAZA ENTRANCE
- 7. VIEWING PATIO
- 8. PARK ENTRANCE
- 9. ACCESSIBLE ACCESS TO ST/BUS
- 10. CONNECTION TO COMMUNITY
- 11. SOCCER PITCH





PROMOTE SOCIALIZATION

The nature of food as a social and cultural connector is leveraged with the strategic placement of the teaching kitchen. Visible from the amphitheatre and directly adjacent to the large multi-purpose room, e-sports area, and reception, this hearth invites passive and active participation; it upholds the value of cooking as a critical tool to build community, strengthen food security, and develop individual skills.





ACCESSIBILITY

Accessibility is paramount in a facility for at-risk youth, aligning with the City of Brampton's elevated Accessibility Standards. Universal washrooms, clear views, inclusive furniture, and unobstructed pathways guarantee compliance with these rigorous standards. This ensures a safe, welcoming environment that goes beyond code requirements to prioritize inclusivity and dignity.





INCLUSIVE

Designed to serve a diverse demographic with different cultural, social, and economic needs, the Youth Hub's spatial organization and materiality are used to clearly signify the purpose of each space. Intuitive wayfinding and signage, easy-to-access technology, and all-gender programs are at the core of the accessibility strategy for the Youth Hub; all intend to create a sense of empowerment and confidence.

The Youth Hub is a dynamic space for young individuals to explore their passions. Featuring an e-sports arena for gaming enthusiasts, a vibrant art studio for creative minds, a top-notch recording studio for music lovers, and versatile multi-purpose rooms accommodating up to 100 people, it's the ultimate destination for youth expression and collaboration.

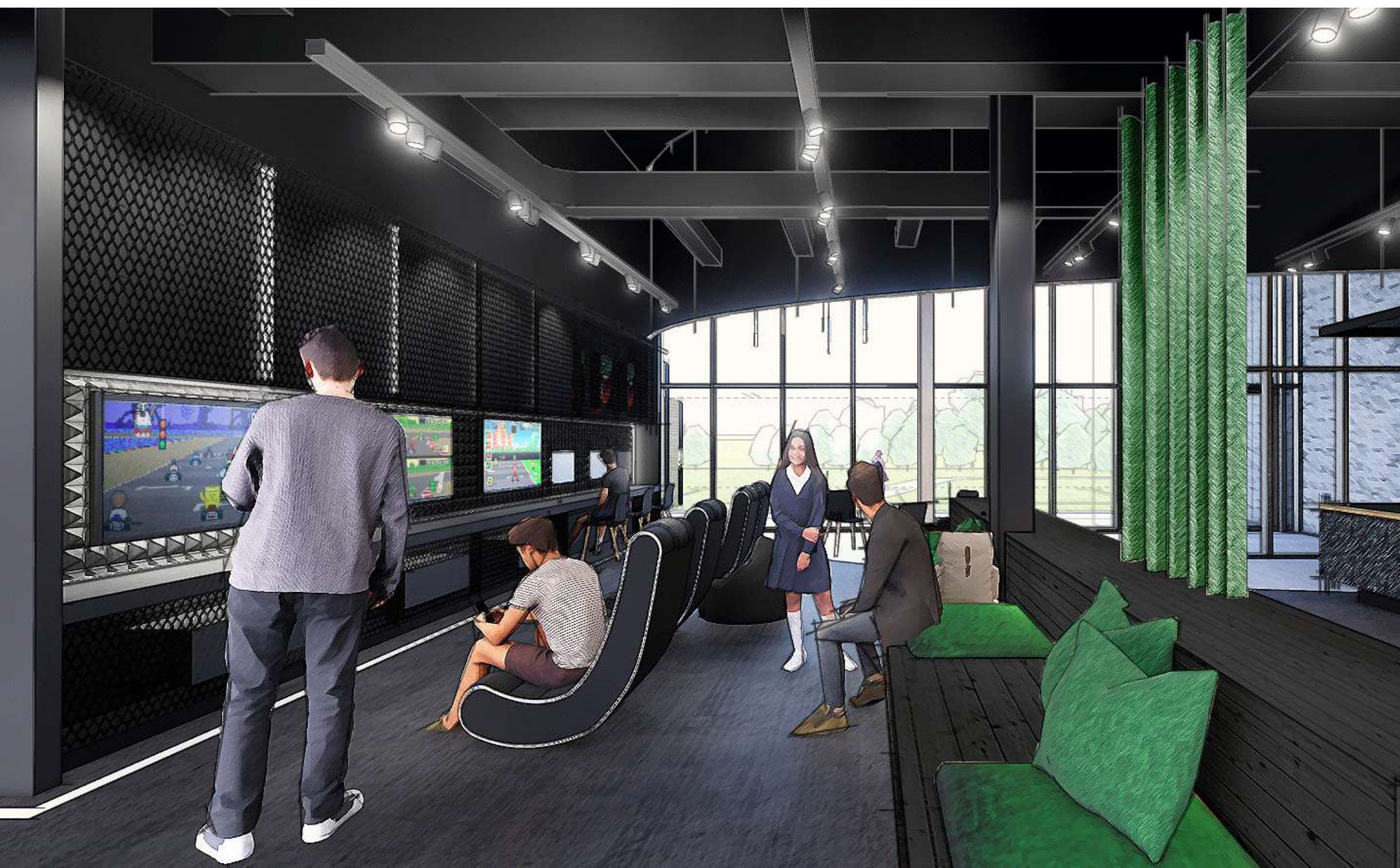



BLOSSOMING CONNECTIONS

The community garden is an integral component of the Youth Hub, seamlessly complementing the teaching kitchen. It serves as an outdoor classroom where young minds learn to nurture the earth and cultivate fresh produce. This hands-on experience not only promotes sustainability but also fosters a sense of responsibility and stewardship among youth.







SUSTAINABILITY

The project outlines a comprehensive framework in line with the Zero Carbon Building standard to achieve ambitious sustainability goals. It prioritizes low-embodied carbon mass timber construction to reduce carbon impact significantly. Passive principles, such as optimizing window sizes and orientations for solar gain and daylight, enhance energy efficiency. An optimal building envelope with low thermal bridging and an airtight seal reduces thermal losses. Fossil fuel-free systems and high-performance mechanical equipment minimize energy consumption and water use. The project also emphasizes air quality, views of nature, and pedestrian-oriented landscape design, creating a holistic and high-quality space that aligns with net-zero readiness.



Early in design, a comprehensive analysis using cove.tool was conducted, including daylight autonomy and parametric assessments. This data-driven approach significantly improved the project's performance by optimizing natural daylighting, enhancing energy efficiency, and reducing long-term operational costs while aligning with sustainability goals.

-  HIGH PERFORMANCE GLAZING

 DAYLIGHT AUTONOMY

 MASS TIMBER SUPERSTRUCTURE

 ROOF MOUNTED PHOTOVOLTAICS

 AIRTIGHT ENCLOSURE
-  ENERGY RECOVERY VENTILATION

 VIEWS TO NATURE

 GEO-EXCHANGE

 RAINWATER COLLECTION & RE-USE

